

PERMISSIVE ACCESS

You are welcome to use this permissive linear access that has been created under Natural England's Environmental Stewardship Scheme. The route extends the network of footpaths available to the public around Huggate and the adjacent stretch of the Wolds Way. The two linear access footpaths provide links to the Open Access (CRoW) Land in Horse Dale and Frenal Dale, close to the Huggate Dikes. The farm is being managed for livestock and wildlife, so please keep dogs under control.

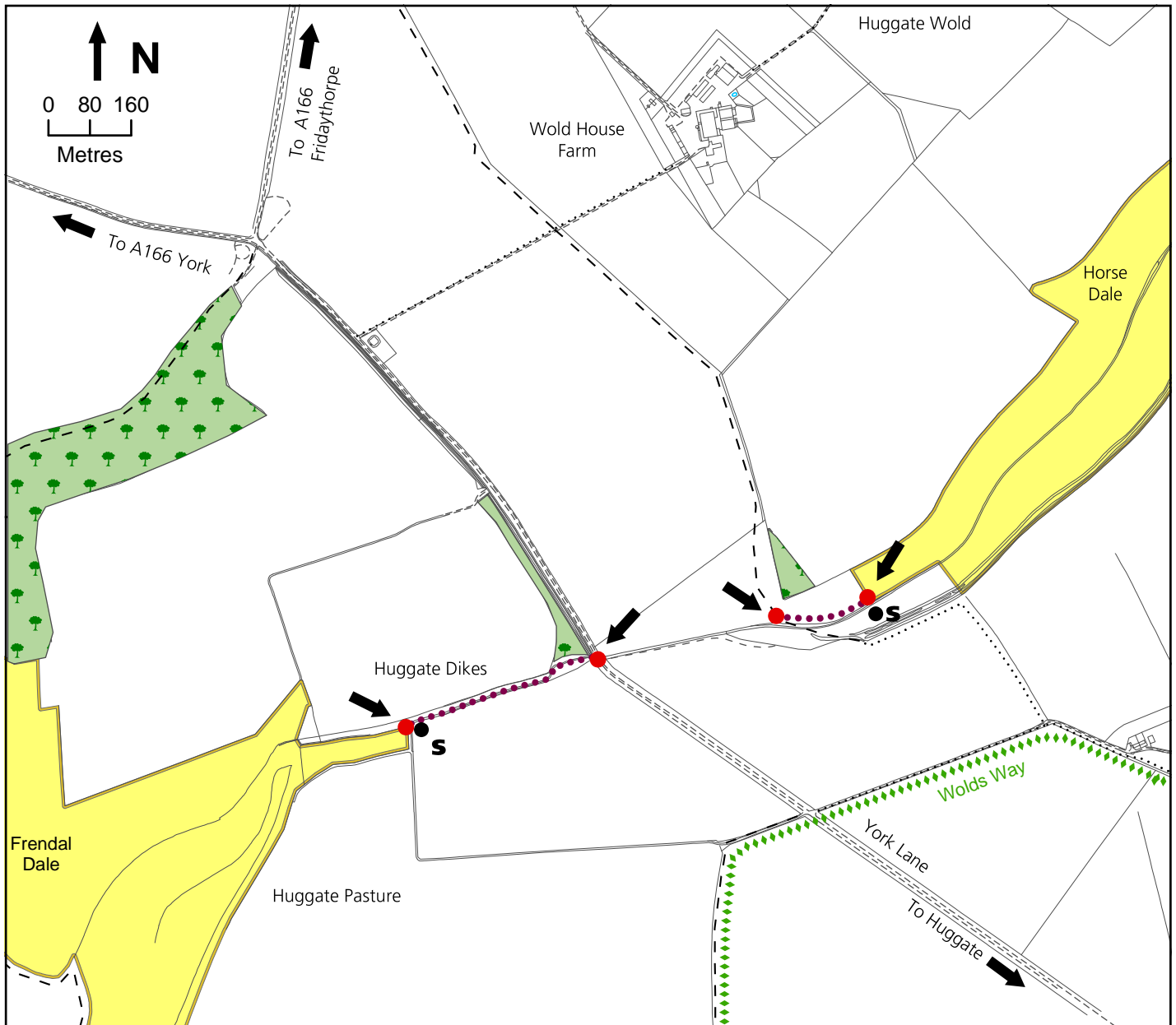

Grid Ref	SE864 562		You Are Here		Permissive Footpath
Ref Nos	AG00217969A 51/410/0011		Entry/exit point		Public Footpath
	S		Deciduous Wood		Public Bridleway
					CRoW Access Land
					National Trail

This access has been provided under the Department for Environment, Food & Rural Affairs' farm conservation schemes as managed by Natural England, which help farmers and land managers protect and improve the countryside, its wildlife and history. It is permissive access and no new rights of way are being created. Existing rights of way are not affected. Please follow the Country Code, any local signs and any CRoW access land restrictions - see www.countrysideaccess.gov.uk. Do not disturb wildlife, livestock or other visitors and in particular keep dogs under control. This is working farmland so please take care; people using this site do so at their own risk. Access ends on 31st October 2016.

For access related queries please call the Access Management Unit on 01902 693218 (Office Hours).
For all other Defra related queries please contact the Defra Helpline on 08459 335577 (Office Hours).

Based on Ordnance Survey mapping with the permission of the Controller of Her Majesty's Stationery Office, © Crown Copyright. Unauthorised reproduction infringes Crown Copyright & may lead to prosecution or civil proceedings. Natural England licence No. 100046223, 2007. The depiction of rights of access does not imply or express any warranty as to its accuracy or completeness.

**ENVIRONMENTAL
STEWARDSHIP
SCHEME**

**COUNTRYSIDE
STEWARDSHIP
SCHEME**

**ENVIRONMENTALLY
SENSITIVE
AREAS**

